

**NOTE: USE BALSA UNLESS OTHERWISE SPECIFIED.**

**1/8" SQ. WING SPAR**

**3/32" PLYWOOD**



**FIREWALL**

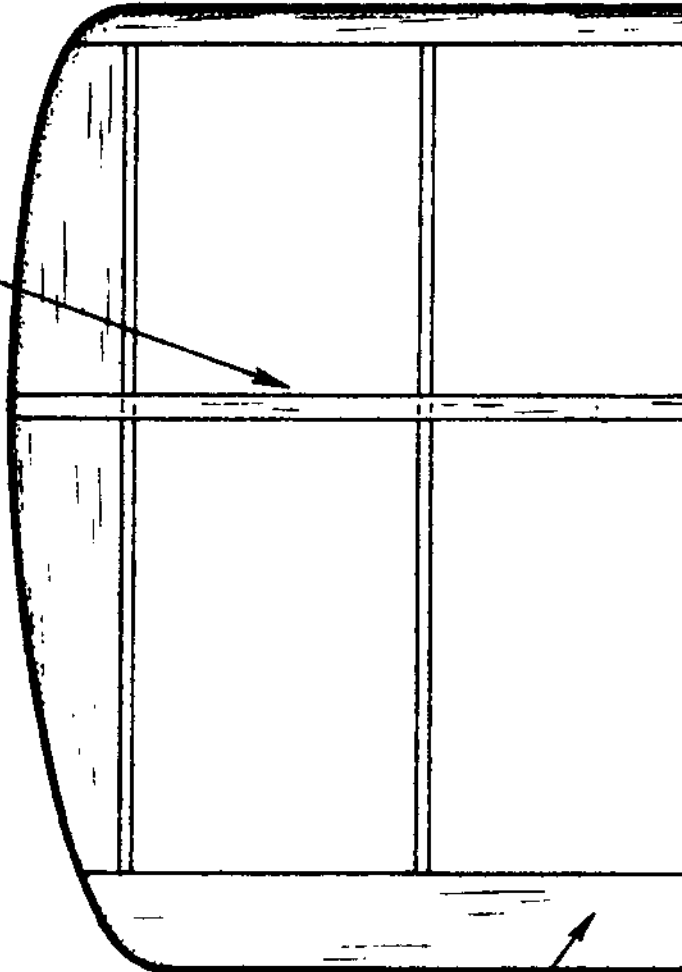

**1/8" x 1/2" TAPERED WING TRAILING EDGE**

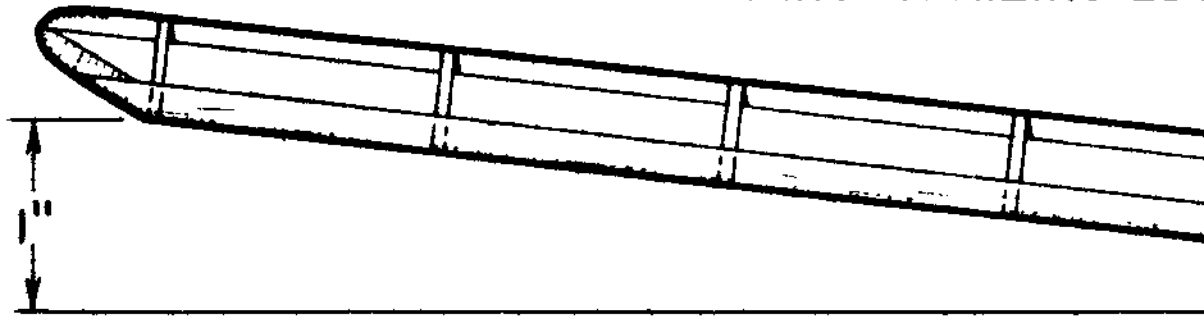

**1/16" SHEET NOSE DOUBLERS**

**1/8" SHEET**



**MO**

1/16" SHEET RIBS

WING PLATE

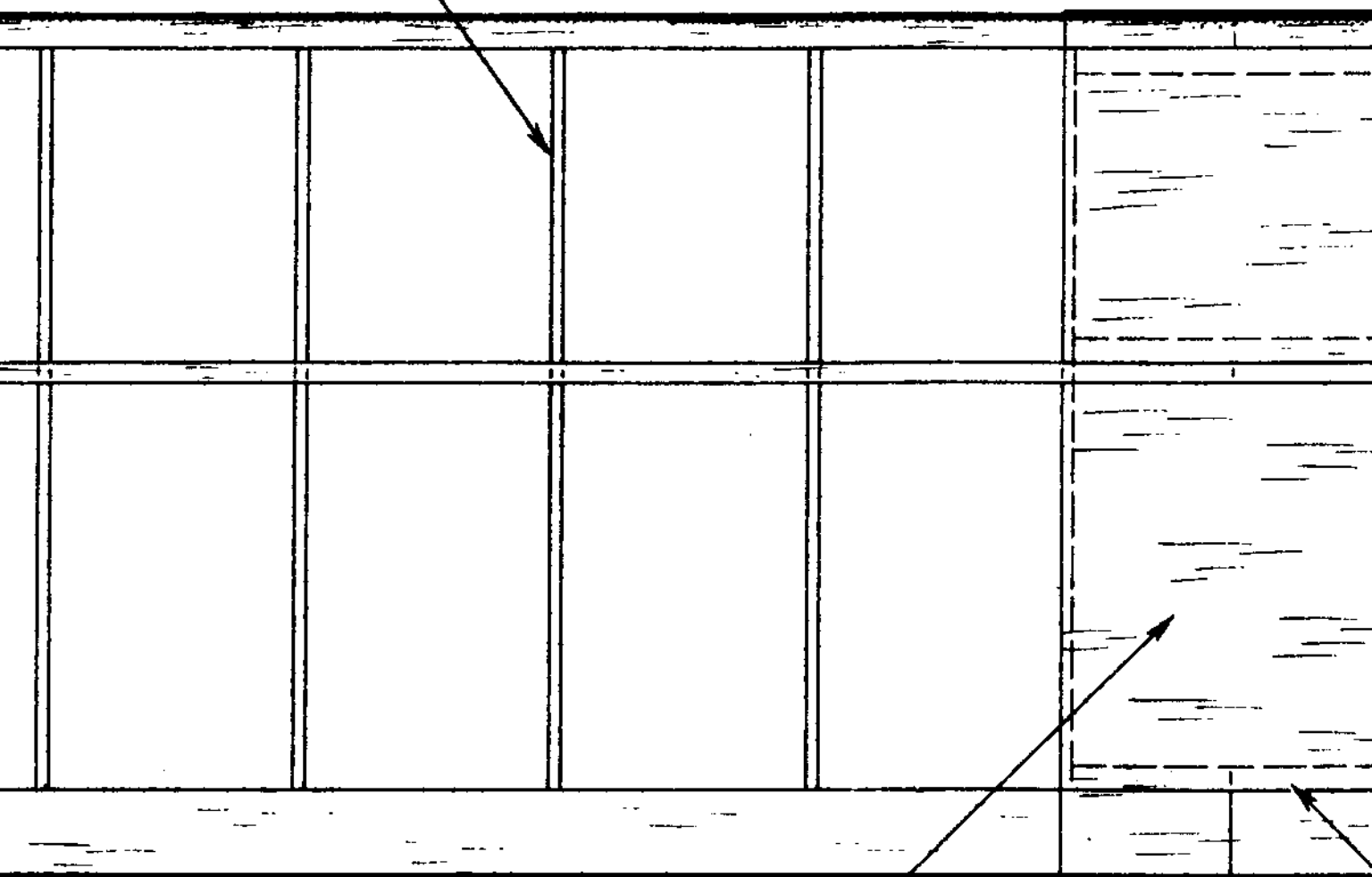

ED  
GE

1/16" SHEET -  
TOP AND BOTTOM

WING FRONT VIEW

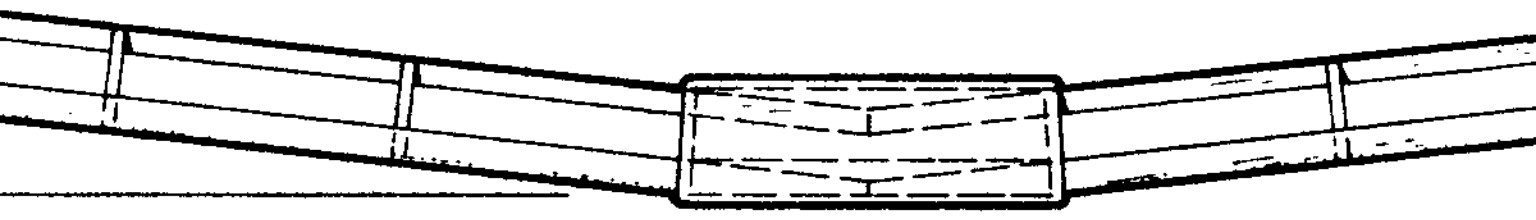

EQUIPMENT  
MOUNTING BASE

SCREW FASTENER

1/8" SQ.

AN

3/16" SQ. LEADING EDGE

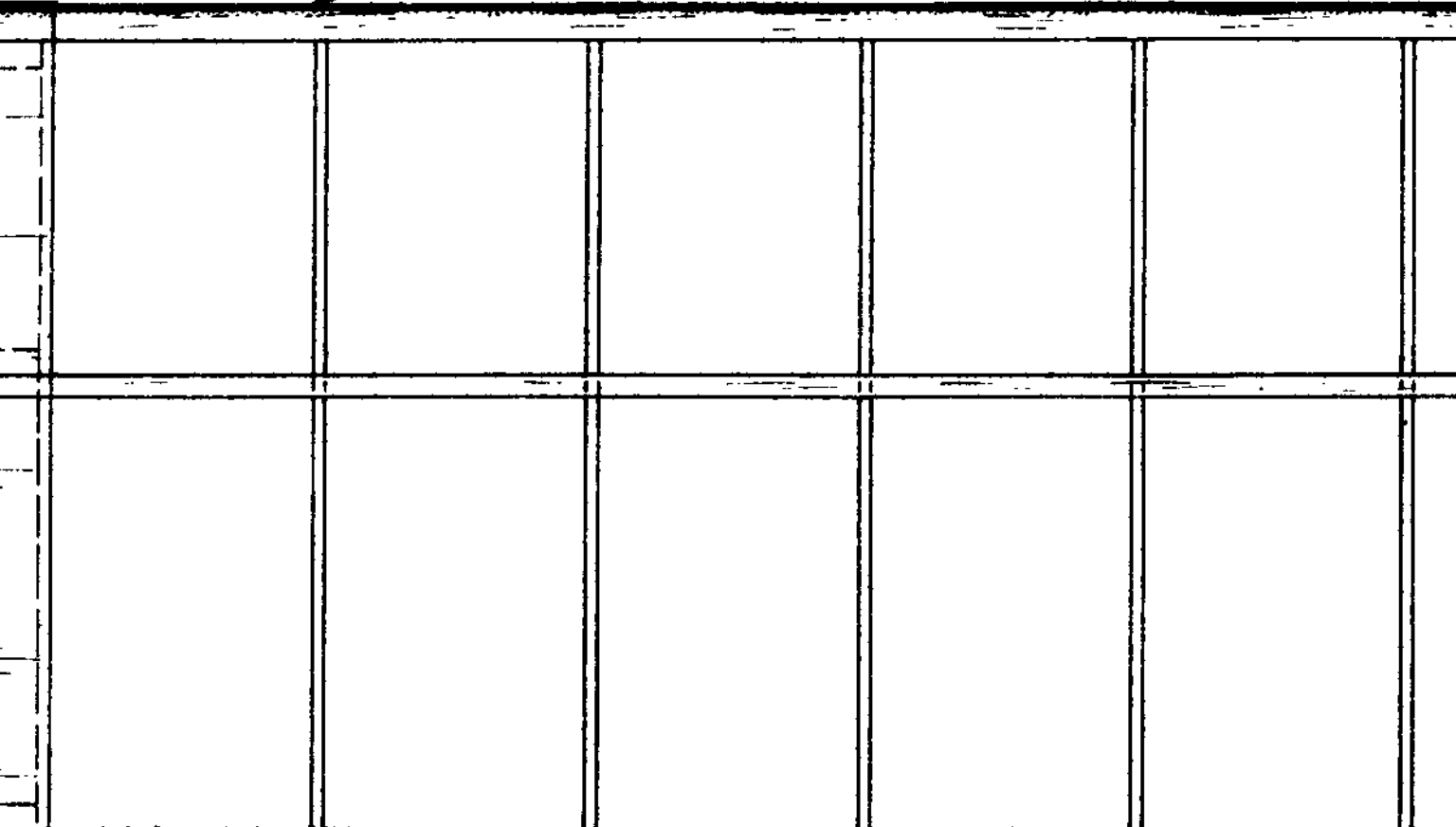

1/8" SHEET  
DIHEDRAL BRACES



1/8" DIAM. DOWEL PEGS

1/8" SQ. TOP STRINGER

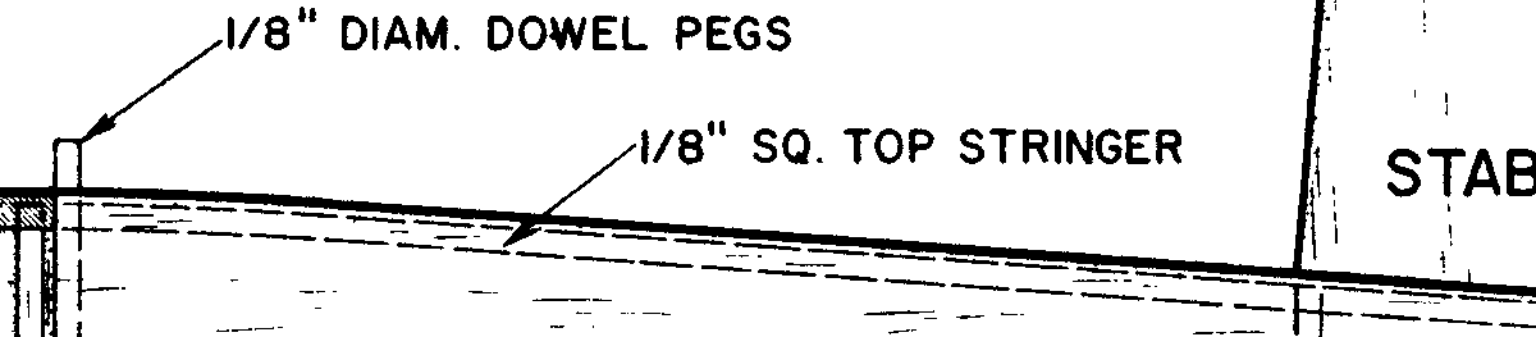

STAB

1/8" SHEET TIPS

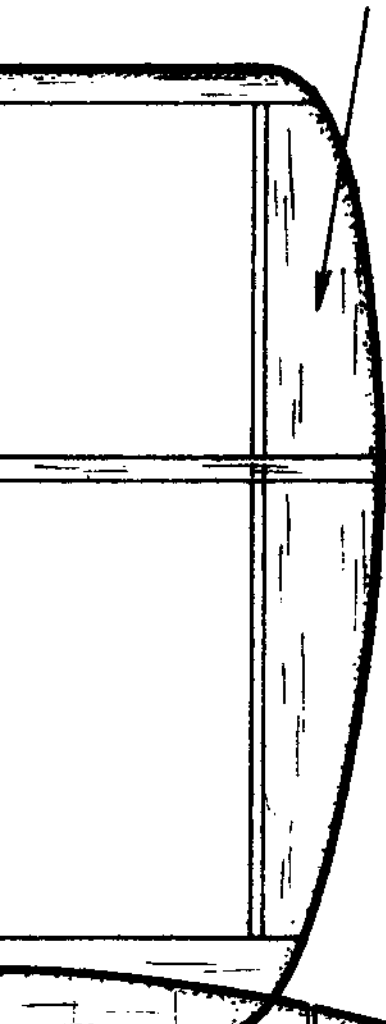

LEADING EDGE



WING SPAR



TRAILING EDGE



DIHEDRAL BRACES

1/16" PLYWOOD



LANDING GEAR BRACE

1/16" SHEET STAB AND ELEVATOR

B PLAN

1/32" DIAM. WIRE



KICKUP



WING MOUNT BRACE

2° RIGHT  
ENGINE  
OFFSET

1/8" HARD SHEET

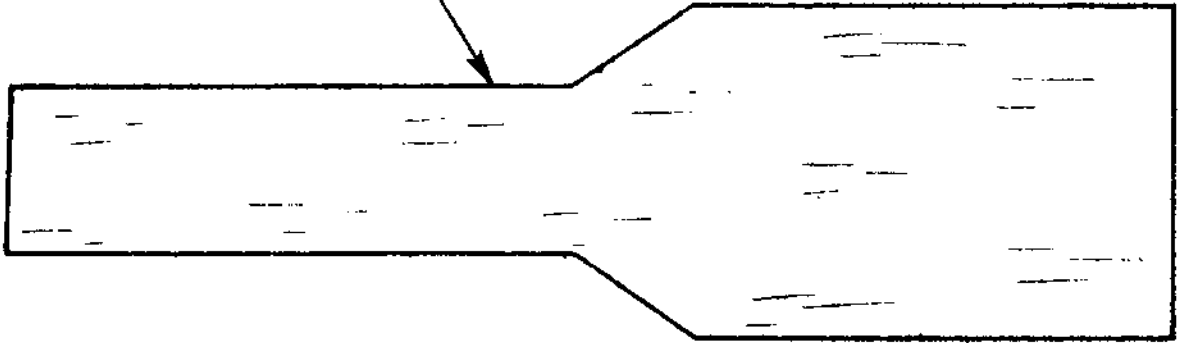

EQUIPMENT MOUNTING BASE

1/8" SHEET

"TEE DEE" .010  
ENGINE SHOWN

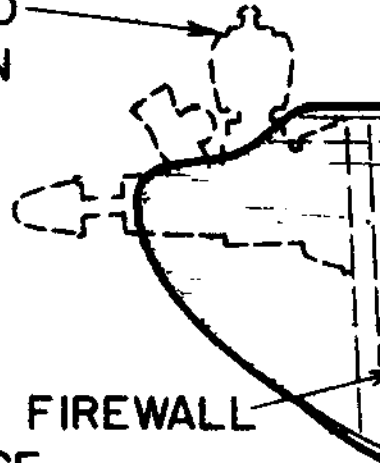

FUSELAGE BOTTOM BRACE

1/8" x 1/4" FIREWALL  
BRACE

FUSELAGE  
BRACE

1/16" DIAM. WIRE

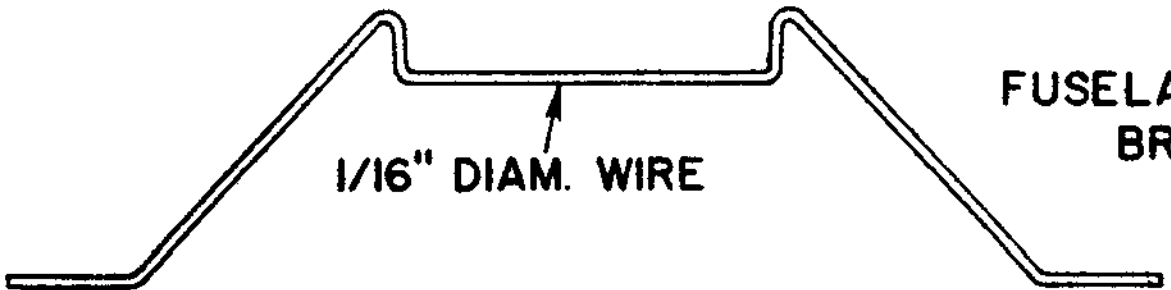

LANDING GEAR STRUT  
LAYOUT

SOLDE



BRACE

FIREWALL

# FUSELAGE TOP VIEW

3/16" FLAT RUBBER CEMENTED TO TOP OF WING MOUNT BASE

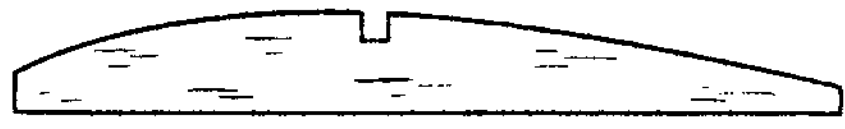

WING RIB TEMPLATE

COMME  
TRIMME

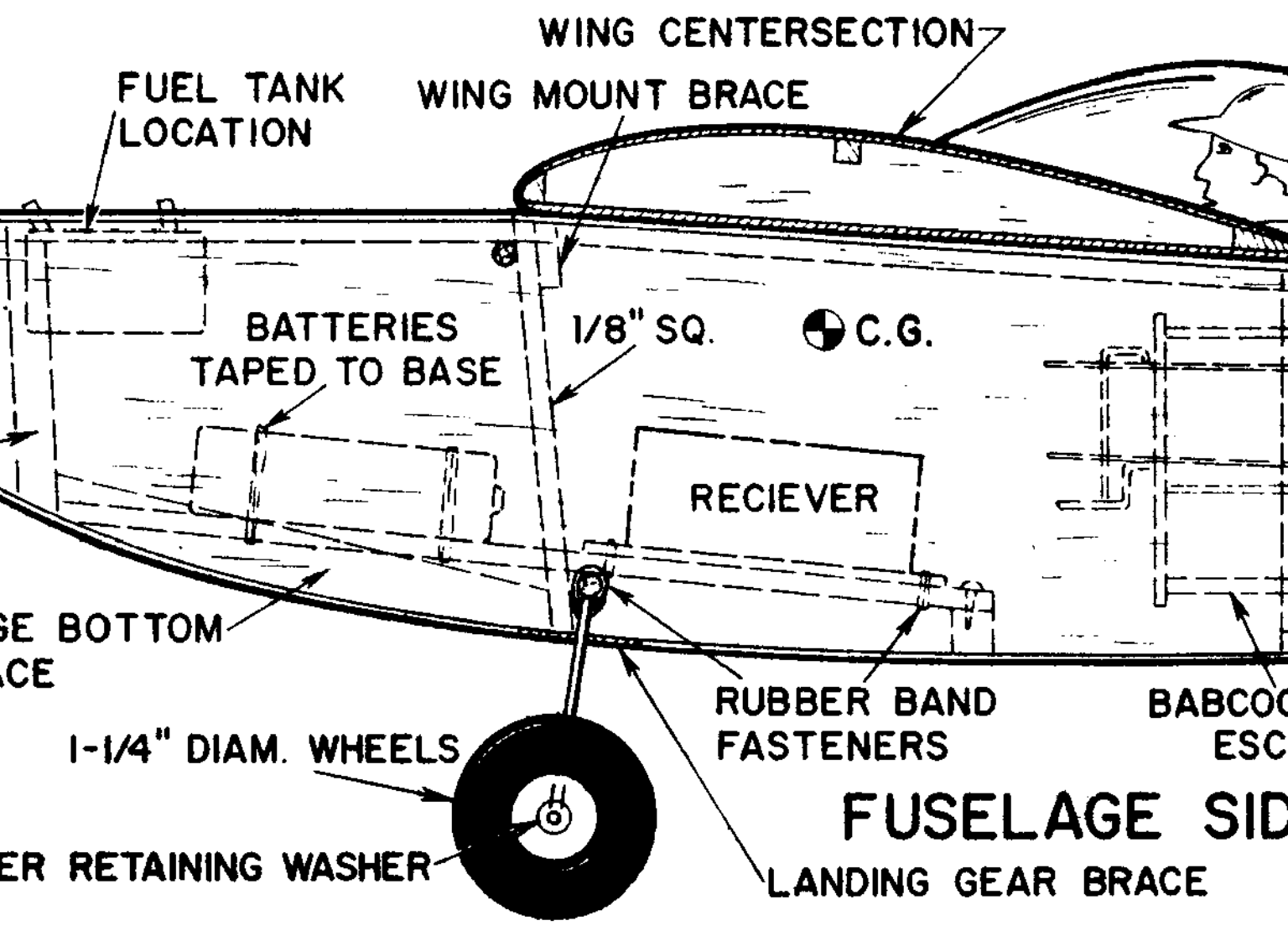

FUEL TANK LOCATION

WING CENTERSECTION

WING MOUNT BRACE

BATTERIES TAPED TO BASE

1/8" SQ.

C.G.

RECIEVER

GE BOTTOM  
CE

RUBBER BAND FASTENERS

BABCOO  
ESC

1-1/4" DIAM. WHEELS

ER RETAINING WASHER

# FUSELAGE SIDE

LANDING GEAR BRACE

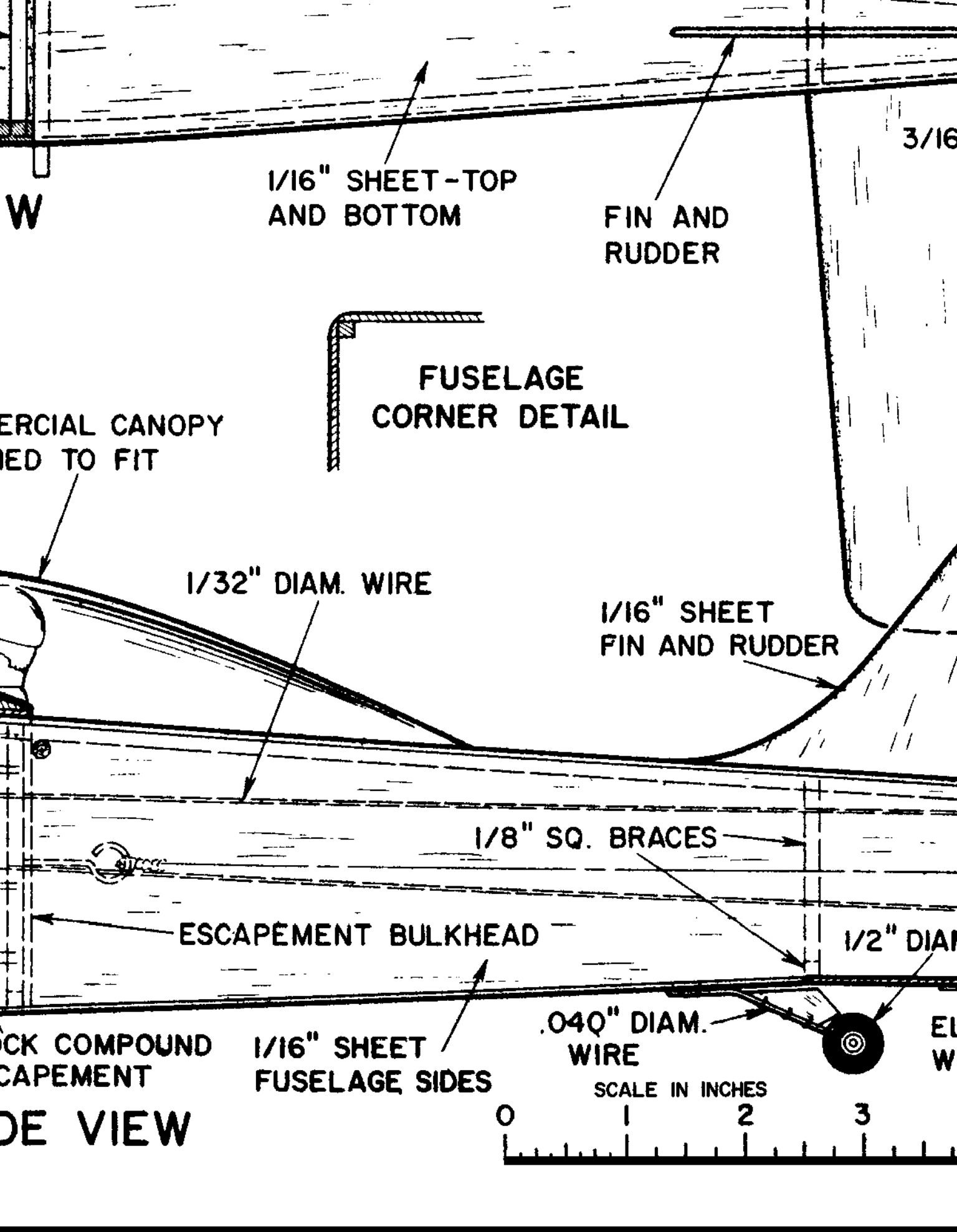

ELEVATOR

"YOKE" DETAIL

6" SHEET

CLOTH TAPE HINGES

1/16" PLYWOOD

MODIFY AS REQUIRED

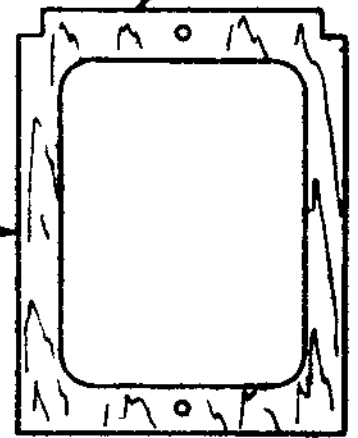

ESCAPEMENT BULKHEAD

CLOTH TAPE HINGES

1/16" PLYWOOD

.040" DIAM. WIRE



TAILPIECE

TUBING

M. WHEEL

ELEVATOR SPRING WIRE ADJUSTER

1/8" SHEET FILL-IN

**"ROARING 20"**

DESIGNED BY: KEN WILLARD

4 5 6 7 8 9 10