

The World's most compact 4-cycle engine

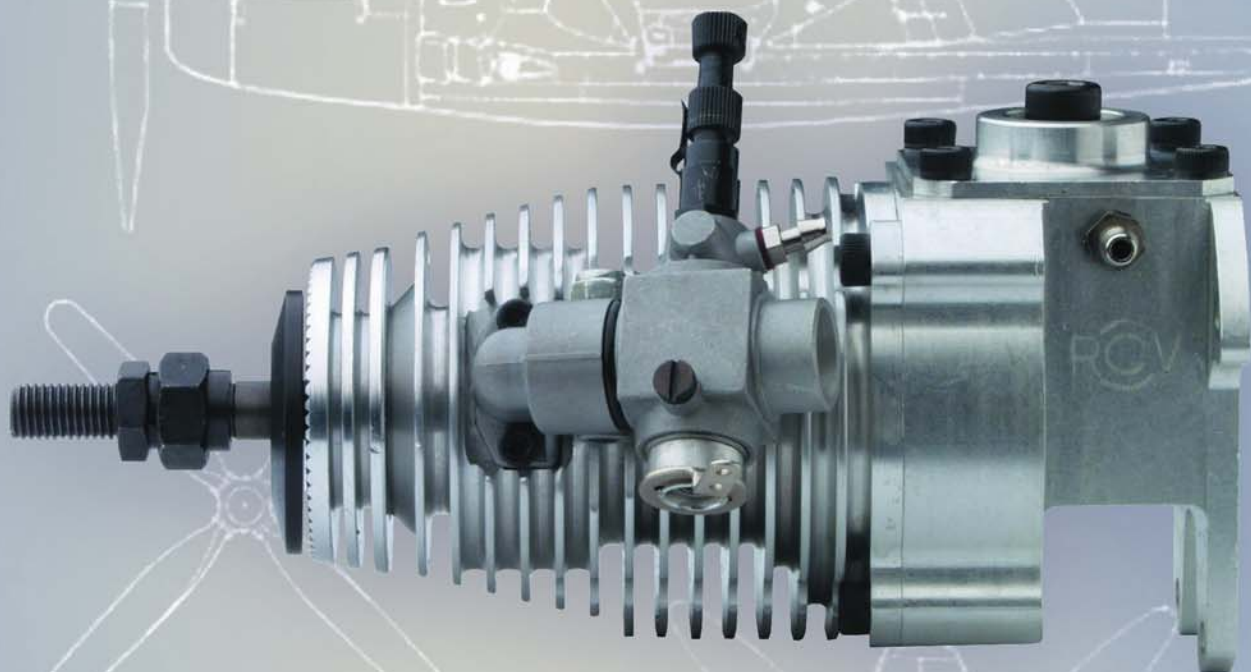

RCV Engines Limited

Designed to fit your Plans...



2 year
International
Warranty

... the Small Engine
with the **Big Heart**

Check out our website for video clips and RCV user photos

www.rcvengines.com

SP series

Designed for Scale Aero-Modelling

'Perfect for your warbirds fits in the cowl and swings scale size props'

The unique RCV technology means the **RCV SP Series** have truly been designed to fit inside your aircraft cowl.

Because of their geared output, they are probably the only engines in their size which can pull large scale propellers, making them the ideal choice for realistic flight. Couple this with the awesome 'merlin' sound and their exceptional fuel efficiency and you're on to a winner.

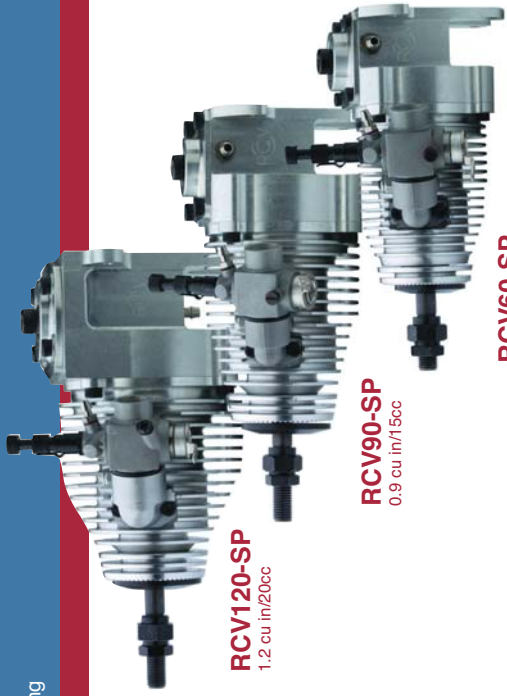

RCV120-SP
1.2 cu in/20cc

RCV90-SP
0.9 cu in/15cc

RCV60-SP
0.6 cu in/10cc

Key features

- Easy to Cowl
- Uses Scale Size Props
- Behind the Prop Starting
- Quality CNC Machined
- Low Maintenance

Dimensions

	A	B	C	D	E	F	G	H	I
RCV60-SP	104.4	Ø72	52	15	4.5	41	30	63	59
RCV90-SP	120	Ø76	56	16	4.5	44	32	67	63
RCV120-SP	125.4	Ø78	70	20	4.5	54	40	79	77

specifications subject to change without notice
all dimensions in mm

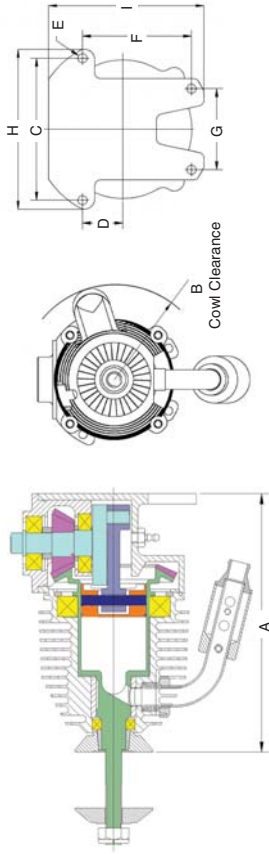

The RCV60SP is easily cowed in this scale 'Spirit of St Louis'

2 x RCV90SPs were the perfect scale option for this winning C-130

A. Elmar and L.O. Netto with their winning B-25 powered by RCV120SPs

The SP series are able to pull scale 3 & 4-bladed props

CD series

Designed for General Aero-Modelling

'Great power for sports compact enough to cowl!'

Having a 20% lower profile than conventional 4-strokes, the **RCV CD series** pack a lot into their compact size using the unique RCV technology.

Scale flyers will love the realistic sound and easy cowling, whilst the effortless starting and handling characteristics make them ideal for trainer and sport use. Couple this with a great price, and it is not surprising that many of our customers are choosing the **RCV CD series** for their multi-engine applications.



RCV130-CD
1.3 cu in /21cc

RCV91-CD
0.91 cu in/15cc

RCV58-CD
0.58 cu in/9.5cc

Key features

- Easy to Cowl
- Realistic Sound
- Easy to Tune
- Exceptional fuel economy
- Low Maintenance

Dimensions

	A	B	C	D	E	F	G	H	I	J	K	L
RCV58-CD	86	68	83.5	106	37.6	41	41.5	58	38	46	55	3
RCV91-CD	103	81.4	95.7	119.7	47	43	48.5	68.5	45	55	65	3.6
RCV130-CD	119	95	108	136	53.6	46	56.6	76.6	49	62	73	0

specifications subject to change without notice
all dimensions in mm

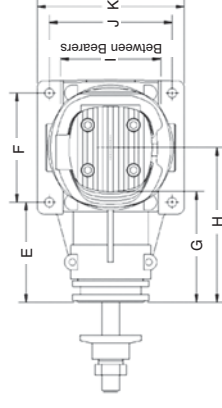
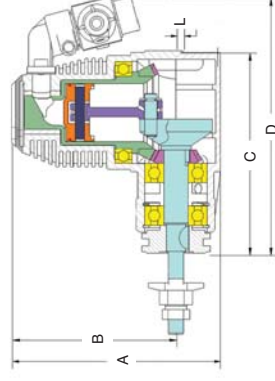

An RCV91CD neatly cowed in a P-51 Mustang



4 x RCV58CDs have powered this B17 for 27 flights and counting



The low height and ability to mount inverted makes for a neat installation



RCV are the engine of choice for this UK based scale warbird team

Join the RCV Revolution

www.rcvengines.com

RCV engines

The World's most compact 4-cycle engine

Since 1997 RCV have exported their patented Rotating Cylinder Valve engines to over fifty countries worldwide

The RCV engine operates on a simple but elegant principle. The cylinder is rotated around the piston at half engine speed via a pair of bevel gears. As the cylinder turns, a port in the cylinder communicates alternately with the inlet and exhaust ports. This provides a compact and simple means of operating a conventional 4 stroke cycle.

RCV are in the process of developing this technology for a wide range of applications, including light transport, forest and garden, and unmanned aerial vehicles.

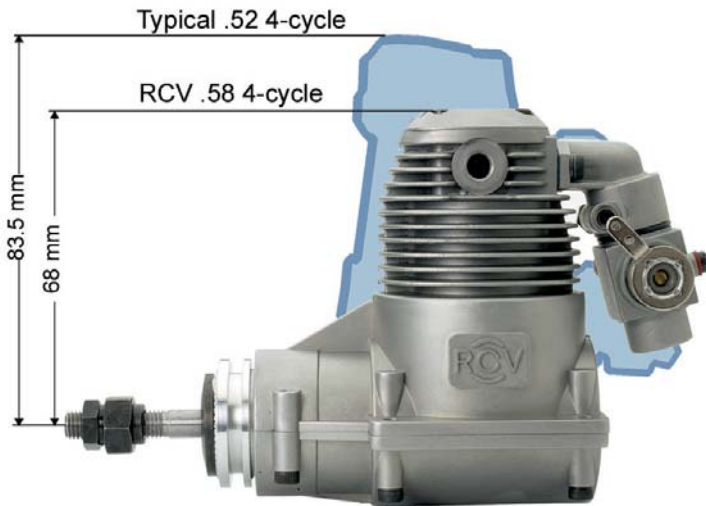
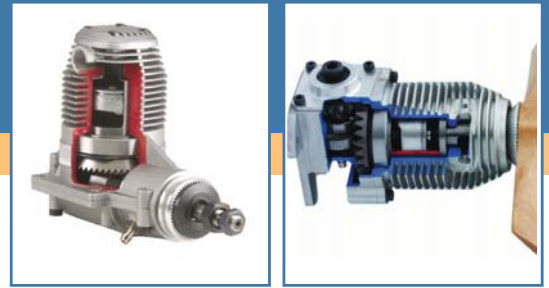

The unique rotating cylinder valve technology means even the conventional shaped CD series have a much lower profile than typical 4-cycle engines

Product Support & Customer Service

RCV go one step further to ensure that our service to you doesn't stop at a great product.

All engines:

- are tested prior to despatch
- have a 2 year warranty
- come with our Lifetime Repair Offer
- have low cost spares

On top of this, we have:

- UK & USA Service Centres
- knowledgeable staff on hand to answer questions by phone, email and letter

Visit your local dealer

RCV engines are available from your local hobby shop or from RCV direct. Further information on our engines and a list of dealers can be found on the RCV website.

Specifications

	RCV60-SP		RCV90-SP		RCV120-SP		RCV58-CD		RCV91-CD		RCV130-CD							
	Imperial	Metric	Imperial	Metric	Imperial	Metric	Imperial	Metric	Imperial	Metric	Imperial	Metric						
Displacement	0.6cu inch	10cc	0.9cu inch	15cc	1.2cu inch	20cc	0.58cu inch	9.5cc	0.91cu inch	15cc	1.3 cu.inch	21.3cc						
Weight (excl. silencer)	20.7oz	570g	28.6oz	785g	36.4oz	1000g	16.2oz	500g	25.2oz	715g	35 oz	995g						
Weight of silencer	1.23oz	35g	1.76oz	50g	1.76oz	50g	1.76oz	50g	1.76oz	50g	3 oz	85g						
Length	4.11"	104.4mm	4.72"	120mm	4.92"	125mm	4.17"	106mm	4.72"	120mm	6.02"	153mm						
Height – centre line axis							2.64"	68mm	3.23"	82mm	3.7"	94mm						
Cowling radius		r36		r38		r39		r70		r85		r99						
Propeller shaft diameter	5/16" UNF		5/16" UNF		5/16" UNF		1/4" UNF		5/16" UNF		5/16 UNF							
Maximum power (approx.)	0.9bhp	0.67kw	1.5bhp	1.12kw	1.8bhp	1.34kw	0.85bhp	0.64kw	1.5bhp	1.12kw	2.0 bhp	1.5kw						
Practical RPM range @prop	1200-6000rpm		1200-6000rpm		1200-6000rpm		2200-12000rpm		2200-11000rpm		2200-10000							
Example prop sizes 2-blade	14x14	15x12W	16x12	16x14	17x13	18x12	16x16	18x12	20x12	11x6	11x7	12x6	13x6	14x6	14x7	15x6,	15x8,	15x10
3-blade	13.4x13.5	15x13.5		15x13.5	15.75x13		15.75x13			11x5			12x7					
4-blade	13x13	14.5x11		15.5x12			15.5x12											
Approx fuel consumption figures	0.4fl oz/min		0.55fl oz/min		0.7fl oz/min		0.3fl oz/min		0.5fl oz/min		0.7fl oz/min							
Recommended fuel	75% Methanol, 10% Nitro, 15% Oil (including between 3 and 6% Castor)																	

RCV Engines Ltd 2007 Protected by International Patents

4 Haviland Road, Ferndown Industrial Estate, Wimborne, Dorset BH21 7RF United Kingdom

Tel: + 44 (0)1202 877044 Fax: + 44 (0)1202 871836

sales@rcvengines.com www.rcvengines.com