



Ida Grove, Iowa 51445 Ph. 712-364-3165

F6F-3 MATERIAL LIST

(Drawings reduced for Informational purposes only)

| Item No. | Description | Qty. |
|-------------|---|------|
| BUNK | | |
| 5931377 | ABS tail hook fair | 1 |
| 5931351 | fiberglass exhaust cap | 1 |
| 5931352 | fiberglass cowl | 1 |
| 5931353 | fiberglass fuselage (front) | 1 |
| 5931354 | fiberglass tail section | 1 |
| 5931355 | fiberglass belly pan | 1 |
| 5931356 | butyl canopy | 1 |
| 5931357 | ABS stab tip (set) | 2 |
| 5931358 | ABS left gear fairing #12 lag | 1 |
| 5931361 | ABS right gear fairing #12 lag | 1 |
| 5931362 | right wire cut foam wing panel | 1 |
| 5931363 | left wire cut foam wing panel | 1 |
| 5931364 | foam stab/elevator | 2 |
| 5930054 | 1/2"x8"x12" latex foam | 1 |
| | owner's manual | 1 |
| | drawings and templates | 1 |
| 4830060 | decal sheet | 1 |
| 4930143 | 12"x48" foam | 1 |
| 5930324 | 18" blue outer nyrod | 1 |
| 2030021 | 36" blue outer nyrod | 1 |
| 2030002 | 48" blue outer nyrod | 4 |
| 5931102 | 18" yellow inner nyrod | 1 |
| 2030020 | 36" yellow inner nyrod | 1 |
| 2030001 | 48" yellow inner nyrod | 4 |
| 2030027 | 1/4" I.D.x32" fiberglass pushrod | 1 |
| 6030589 | 1/16"x19-1/2"x12-1/2" die-cut plywood | 1 |
| 6030590 | 1/32"x16"x9-1/2" die-cut plywood | 2 |
| 6030591 | 1/8"x28-5/8"x14-1/8" die-cut plywood | 1 |
| 6030593 | 1/8"x25-1/2"x14-1/8" die-cut plywood | 1 |
| 6030581 | Bag #1 fuselage hardware | 1 |
| 6030582 | Bag #2 fuel tank hardware | 1 |
| 6030583 | Bag #3 wing hardware | 1 |
| 6030584 | Bag #4 wing wood | 1 |
| 6030585 | Bag #5 tail group hardware | 1 |
| 6030586 | Bag #6 tail group wood | 1 |
| 6030587 | Bag #7 servo linkage | 1 |
| 6030588 | Bag #8 accessory | 1 |
| 6030389 | Bag #9 retract tail wheel (option) | 1 |
| 6030388 | Bag #10 pneumatic system (option) | 1 |
| 6030377 | Bag #11 5-1/4" tire (option) | 2 |
| 6030592 | Bag #12 gear strut fairing (option) | 1 |
| 5931165 | 1/16"x7-1/2"x12-1/2" sheet ply | 1 |
| 6030581 | Bag #1 (fuselage hardware) | 1 |
| 5931366 | 3/8"x3/4"x6-1/2" left landing gear rail | 2 |
| 5931367 | 3/8"x3/4"x6-1/2" right landing gear rail | 2 |
| 0730038 | eye hook | 12 |
| 0730142 | #1/4"-20x1/2" nylon bolt | 3 |
| 0730066 | #4x3/4" sheet metal screw | 12 |
| 0730073 | #4-40x1/2" flat head bolt | 4 |
| 0730115 | #10-32x1/4" socket head bolt | 2 |
| 1330211 | #4 flat steel washer | 10 |
| 1430500 | #8-32 blind T-nut | 6 |
| 1430556 | #4-40 blind T-nut | 8 |
| 5930850 | aluminum cowl bracket | 3 |
| 5930878 | 1" aluminum extrusion | 2 |
| 5930973 | 1/4" square x 3" spruce | 2 |
| 0730065 | #2x3/8" slotted pan head sheet metal screws | 10 |
| 2431199 | nylon pushrod exit guide | 4 |
| 0730097 | #4-40x1/2" pan head bolt | 10 |
| 1410009 | #4-40 hex nut | 6 |
| 5930421 | aluminum bar clamp | 3 |
| 0730076 | #4-40x1-1/4" pan head bolt | 3 |
| 2431118 | nylon aileron connector | 2 |
| 5931375 | 1/4" dia.x.035"x12-3/8" alum. torque tube | 1 |

| Item No. | Description | Qty. |
|----------|--|------|
| 5931376 | 1" spacers | 2 |
| 2431122 | 1/4" nylon bushing | 2 |
| 2431170 | nylon clevis #29 | 1 |
| 2431169 | nylon swivel #29 | 1 |
| 2431073 | #2-56 ball link | 1 |
| 1430478 | #2-56 hex nut | 1 |
| 2431020 | nylon SK ball socket | 1 |
| 2431067 | #2-56x1-1/2" threaded rod | 2 |
| 6030582 | Bag #2 (fuel tank hardware) | 1 |
| 2431104 | fuel filler with 2 nuts | 2 |
| 2431139 | nylon tie wrap | 4 |
| 2431146 | #64 rubber band | 6 |
| 2431189 | Dubro S-24 tank | 1 |
| 5930956 | fuel stopper assembly | 1 |
| 5930973 | 1/4" square x 3" spruce | 1 |
| 5931006 | Buna fuel line 36" | 1 |
| 5931089 | 1/8"x2-1/2"x7" plywood | 1 |
| 6030583 | Bag #3 (wing hardware) | 1 |
| 2431073 | #2-56 ball link | 2 |
| 0730036 | #4-40x1-1/4" pan head bolt | 2 |
| 2431018 | #4-40 threaded ball link | 2 |
| 5931095 | 7/32" O.D.x2" brass tube | 6 |
| 2431171 | Robart super hinge | 6 |
| 2431178 | lead weights (fish sinkers) | 2 |
| 5930344 | #4-40x4" threaded rod | 2 |
| 5931074 | 1/4" diameter x 2" wooden dowel | 4 |
| 5931094 | 1/8"x1x7" aluminum spar | 2 |
| 5930676 | 1/8" O.D.x1" brass tube | 2 |
| 5930628 | 1/4" diameter x 3" wooden dowel | 1 |
| 6030584 | Bag #4 (wing wood) | 1 |
| 3930061 | 1/4"x4"x36" sheet balsa | 1 |
| 3930039 | 1-1/2"x2"x12" balsa block | 2 |
| 5931368 | 1"x7/8"x8-1/2" balsa block | 2 |
| 3930077 | 3/32"x4"x36" balsa sheet | 14 |
| 5931359 | 1/2"x1-1/4"x36" tapered trailing edge balsa | 2 |
| 5931369 | 1/8"x1-3/4"x2-1/2" plywood | 2 |
| 6030585 | Bag #5 (tail group hardware) | 1 |
| 0730093 | #4-40x2" pan head bolt | 1 |
| 2431171 | Robart super hinge | 11 |
| 5931074 | 1/4" O.D.x2" wooden dowel | 1 |
| 5931095 | 7/32" O.D.x2" brass tube | 11 |
| 5931171 | 1/8" diameter x 2" music wire | 2 |
| 2431118 | nylon connector | 2 |
| 2431072 | 1/8" wheel collar with set screw | 2 |
| 2431018 | #4-40 ball link | 2 |
| 5931365 | 1/4" diameter x 4" wooden dowel | 1 |
| 6030586 | Bag #6 (tail group wood) | 1 |
| 3930080 | 1/32"x2"x36" balsa sheet | 1 |
| 3930074 | 1/16"x4"x36" balsa sheet | 5 |
| 3930065 | 1/8"x4"x36" balsa sheet | 1 |
| 3930061 | 1/4"x4"x36" balsa sheet | 2 |
| 5931370 | 1"x2-1/4"x8" balsa block | 2 |
| 5931371 | 1"x1-1/2"x4-1/2" balsa block (cut from 3930043, 1"x3"x18") | 1 |
| 3930091 | 3/4"x2"x12" balsa block | 1 |
| 5931372 | 1/8"x1"x12" plywood stab spar | 1 |
| 6030587 | Bag #7 (servo linkage) | 1 |
| 2431073 | #2-56 threaded ball link | 7 |
| 2431120 | nylon SK ball socket | 9 |
| 2431018 | #4-40 threaded ball link | 2 |
| 2431030 | #2-56 threaded steel clevis | 10 |

| Item No. | Description | Qty. |
|----------|---|-------|
| 1430478 | #2-56 hex nut | 8 |
| 2431067 | #2-56 x 1-1/2" threaded rod | 2 |
| 2431066 | #2-56x4" rod threaded both ends | 2 |
| 2431028 | #2-56x4" rod threaded one end | 6 |
| 2431211 | #2-56x6" rod threaded both ends | 2 |
| 3530033 | large plastic pushrod end | 2 |
| 2431151 | #2-56 threaded missing link #78 | 4 |
| 0730041 | #2-56x3/4" pan head bolt | 2 |
| 1330206 | 3/8" diameter washer with a #2 hole | 4 |
| 6030588 | Bag #8 (accessories) | 1 |
| 2431044 | 9/64" ball driver | 1 |
| 2431045 | 5/32" ball driver | 1 |
| 2431052 | awl | 1 |
| 2431083 | Loctite (blue) | 1 |
| 5931373 | 19"x20" 2 oz. glass cloth | 1 |
| 5931099 | 19"x36" 6 oz. glass cloth | 1 |
| 6030389 | Bag #9 (retract tail wheel option) | 1 |
| 5930785 | D&B retract unit (includes 1/16" air line) | 1 |
| 5930402 | 5/32" diameter strut wire | 1 |
| 2431070 | 5/32" wheel collar/set screw | 1 |
| 2431113 | 2" Robart tire | 1 |
| 0730104 | #4x1/2" pan head sheet metal screw | 4 |
| 6030388 | Bag #10 (pneumatic system) optional | 1 |
| 2431093 | 1/16" tees | 4 |
| 2431095 | air fill valve | 1 |
| 2431096 | air pressure gauge | 1 |
| 2431099 | air bottle cap | 1 |
| 5930920 | bottle stopper | 1 |
| 2431164 | single spool valve | 1 |
| 2431167 | 1/16" wheel collar/set screw | 2 |
| 5930787 | 3/64" diameter x 6" length wire | 1 |
| 5930788 | 2" yellow nyrod | 1 |
| 5930407 | 1/16" air line (10') | 1 |
| 2431098 | air bottle | 1 |
| 0730005 | #2x3/4" slotted pan head sheet metal screw | 2 |
| 6030377 | Bag #11 (wheel) optional | 2 |
| 5930258 | 1/4" diameter axle | 1 |
| 5930884 | 5-1/4" diameter block tread tire | 1 |
| 5931057 | outer hub drilled | 1 |
| 5931058 | inner hub tapped | 1 |
| 2431092 | 1/4" wheel collar/set screw | 2 |
| 0730055 | #6-32x1-1/4" hex head bolt | 6 |
| 1330064 | nylon washer | 1 |
| 6030592 | Bag #12 (gear strut fairings) option | 1 |
| 5931174 | 5/8" diameter x 1/4" plastic ring | 2 |
| 0730040 | #1/4"-20x2" nylon bolt | 1 |
| 0730065 | #2x3/8" slotted pan head sheet metal screw | 16 |
| 0730081 | #2-56x1/4" slotted pan head bolt | 4 |
| 1330206 | 3/8" diameter washer with a #2 hole | 2 |
| 2131219 | coiled hinge spring | 2 |
| 2431067 | #2-56x1-1/2" threaded rod | 1 |
| 2431175 | Dubro hinge (large) | 4 |
| 3530033 | pushrod end (large) | 2 |
| 5930787 | 3/64" diameter x6" hinge wire | 1 |
| 2630086 | Robart 100° rotating mains (optional) | 1 set |
| 5931358 | LH gear fairing, ABS | 1 |
| 5931361 | RH gear fairing, ABS | 1 |

Byron Originals, Inc. - P.O. Box 279 - Ida Grove, IA 51445 - Ph: (712) 364-3165

F6F-3 HELLCAT

EXPLODED VIEW

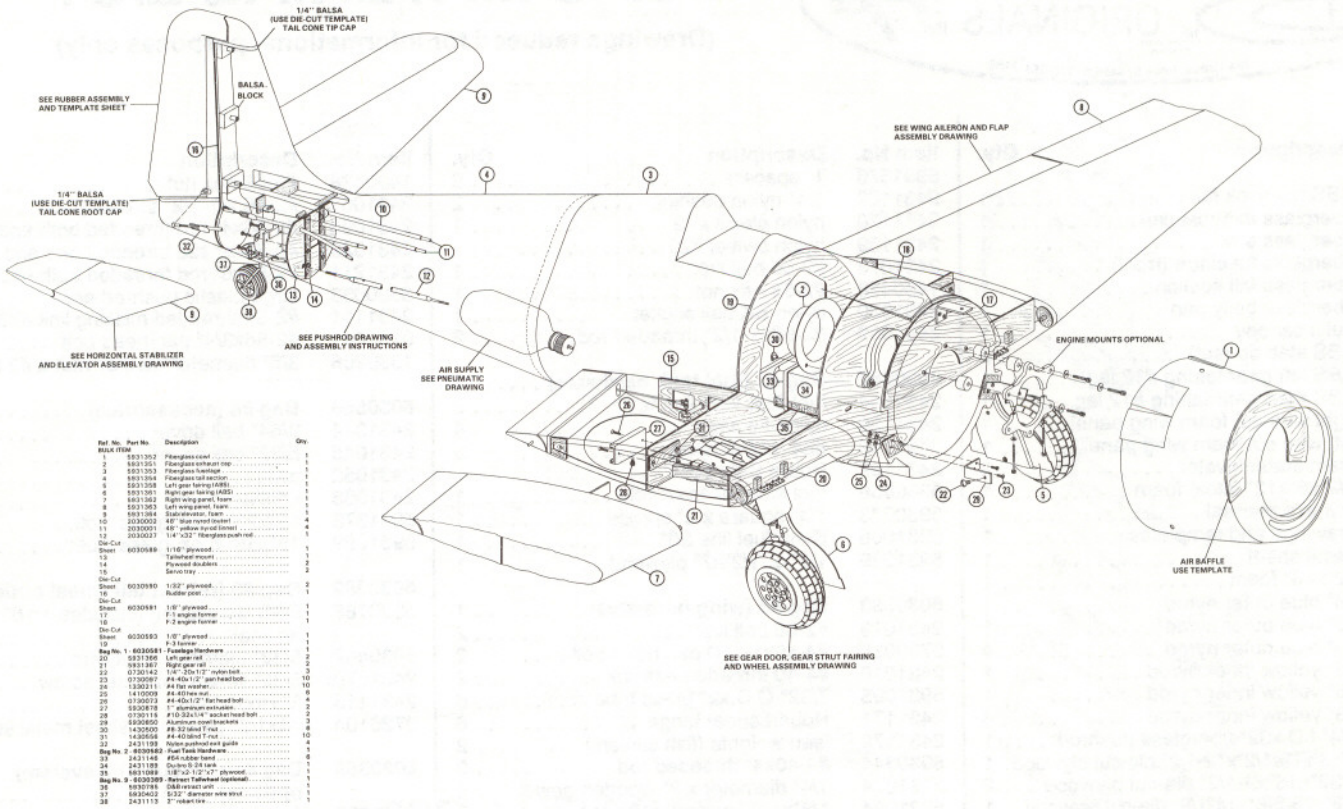

F6F-3 HELLCAT TOP VIEW

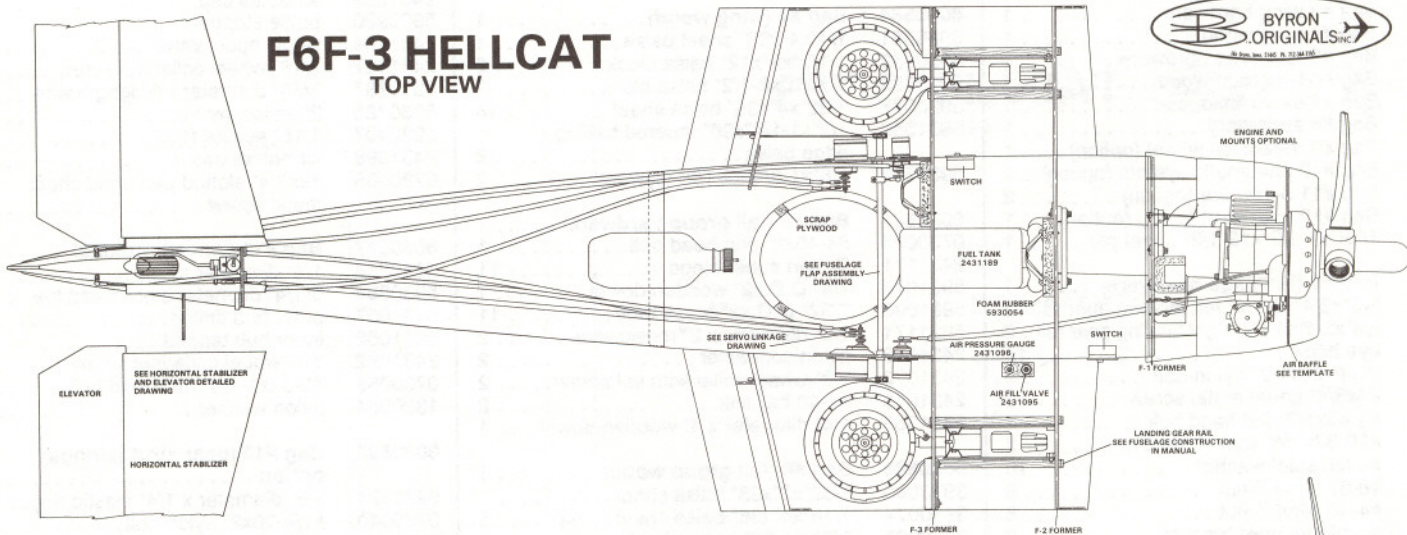

F6F-3 HELLCAT SIDE VIEW

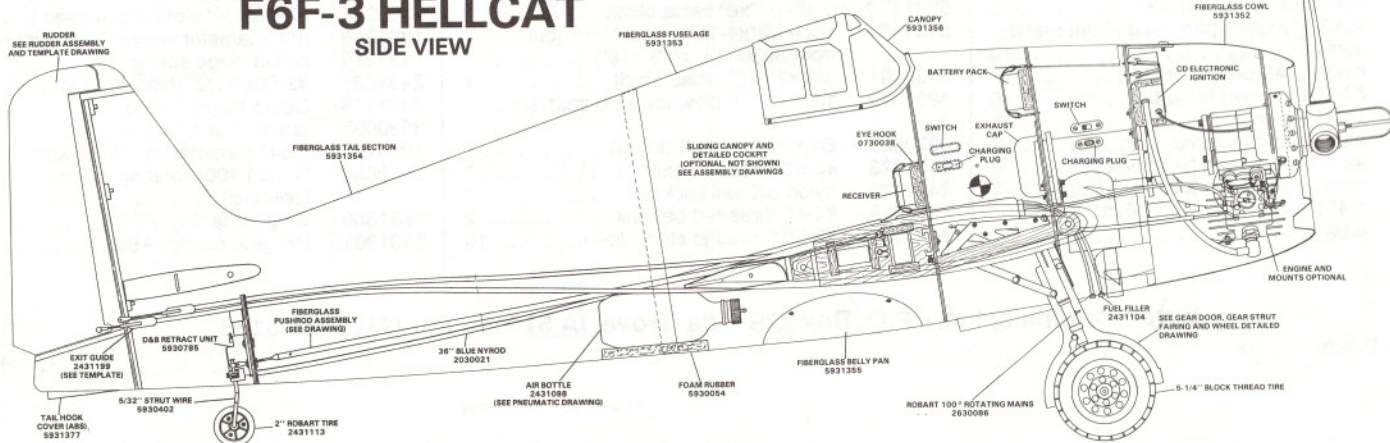

F6F-3 HELLCAT

HORIZONTAL
STABILIZER AND
ELEVATOR ASSEMBLY
BOTTOM VIEW (LEFT)

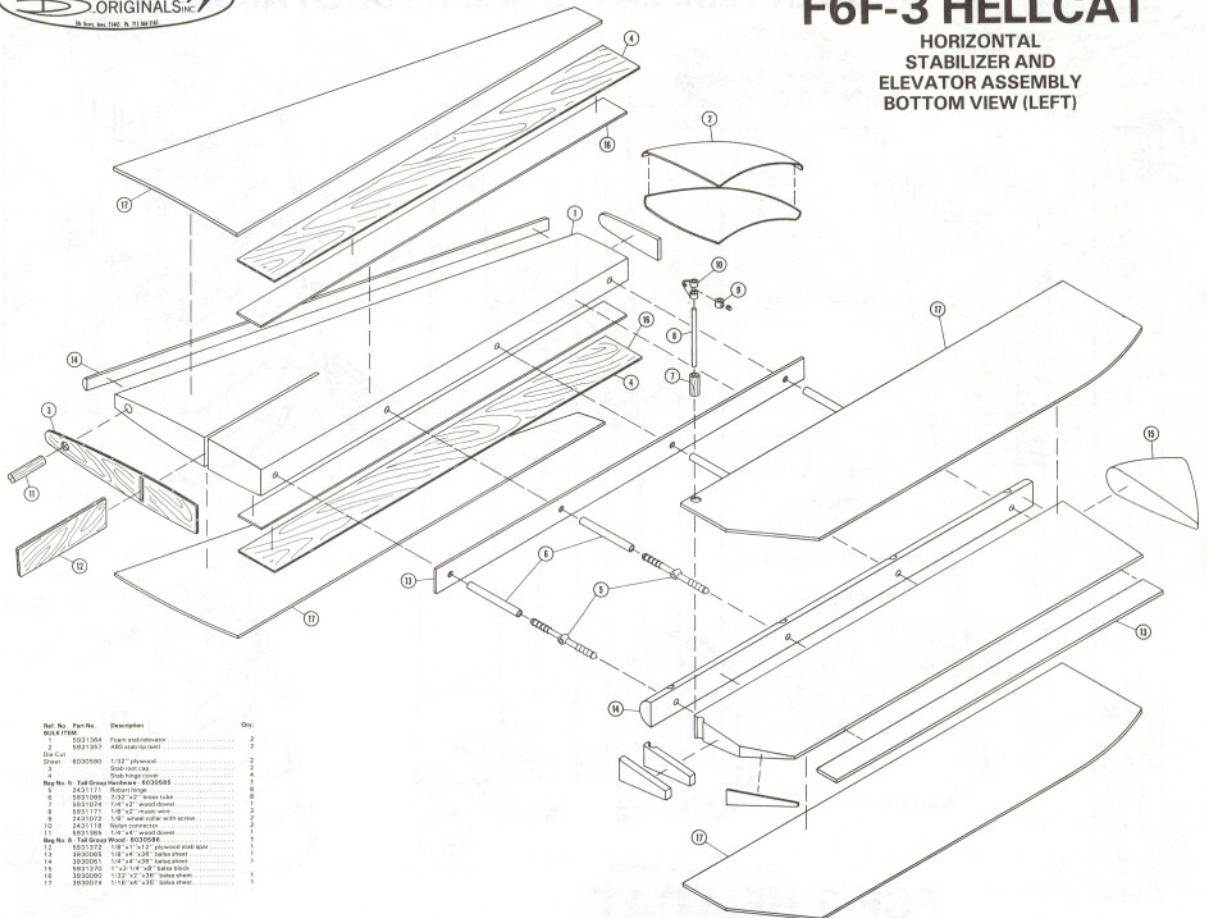

| Ref. No. | Part No. | Description | Qty. |
|--|----------|----------------------------------|------|
| Wing/Elev | | | |
| 1 | 5031506 | Front stabilizer | 2 |
| 2 | 5031557 | ABS stabilizer | 2 |
| She-Cut | | | |
| 3 | 6030580 | 1/32" plywood | 2 |
| 4 | | Sub-rib cap | 2 |
| Bag No. 5 Tail Group Hardware #030585 | | | |
| 5 | 2431171 | Adaptage | 6 |
| 6 | 5031026 | 1/32" x 1/2" brass tube | 8 |
| 7 | 6031025 | 1/4" x 1/2" wood dowel | 2 |
| 8 | 5031171 | 1/8" x 1/2" brass wire | 2 |
| 9 | 2431023 | 1/8" x 1/2" brass wire with stop | 2 |
| 10 | 2431118 | Nylon connector | 2 |
| 11 | 5031065 | 1/4" x 1/2" wood dowel | 2 |
| Bag No. 6 Tail Group Wood #030586 | | | |
| 12 | 5031072 | 1/8" x 1/2" plywood sub-rib | 1 |
| 13 | 3630061 | 1/8" x 1/4" x 3/16" tab sheet | 1 |
| 14 | 3630062 | 1/4" x 1/4" x 3/16" tab sheet | 1 |
| 15 | 6031024 | 1/2" x 1/4" x 1/2" tab sheet | 1 |
| 16 | 3630060 | 1/32" x 1/2" x 1/8" tab sheet | 1 |
| 17 | 2850074 | 1/16" x 1/8" x 1/8" tab sheet | 1 |

F6F-3 HELLCAT

WING, AILERON AND
FLAP ASSEMBLY
BOTTOM VIEW
LEFT WING

| Ref. No. | Part No. | Description | Qty. |
|--|----------|----------------------------------|------|
| Wing/Elev | | | |
| 1 | 5031282 | Right wing panel (not shown) | 1 |
| 2 | 5031282 | Left wing panel (shown) | 1 |
| She-Cut | | | |
| 3 | 6030580 | 1/8" plywood | 1 |
| 4 | | Wood spar | 1 |
| She-Cut | | | |
| 5 | 6030589 | 1/16" plywood | 1 |
| 6 | | Wing cap | 2 |
| She-Cut | | | |
| 7 | 6030590 | 1/32" plywood | 2 |
| 8 | | Flap top cap | 2 |
| 9 | | Flap top cap | 2 |
| 10 | | Aileron top cap | 2 |
| 11 | | Aileron top cap | 2 |
| Bag No. 3 Wing Hardware #030583 | | | |
| 12 | 5031074 | 1/4" x 1/2" wood dowel | 4 |
| 13 | 5031064 | 1/8" x 1/2" brass tube | 2 |
| 14 | 5031026 | 1/4" x 1/2" wood dowel | 2 |
| 15 | 0730026 | #4 40s 1.14" diam head bolt | 2 |
| 16 | 2431018 | A4 40s brass nut | 2 |
| 17 | 2431019 | #2 SS lock | 2 |
| 18 | 5030344 | #4 40s 1/2" brass nut | 2 |
| 19 | 2431118 | Lead weight flat washer | 2 |
| 20 | 2431171 | Rubber stop ring | 2 |
| 21 | 5031025 | 7/32" x 1/2" brass tube | 2 |
| 22 | 5030316 | 1/8" x 1/2" brass tube | 2 |
| Bag No. 4 Wing Wood #030584 | | | |
| 23 | 3630077 | 3/32" x 1/2" x 1/8" tab sheet | 14 |
| 24 | 3630078 | 1/2" x 1/4" x 1/8" trailing edge | 2 |
| 25 | 3630079 | 1/2" x 1/4" x 1/2" tab sheet | 2 |
| 26 | 5031026 | 1/4" x 1/2" wood dowel | 2 |
| Bag No. 5 Servo Linkage #030585 | | | |
| 27 | 2431020 | #2 SS steel clevis | 2 |
| 28 | 2431066 | #2 SS threaded nylon ends | 2 |

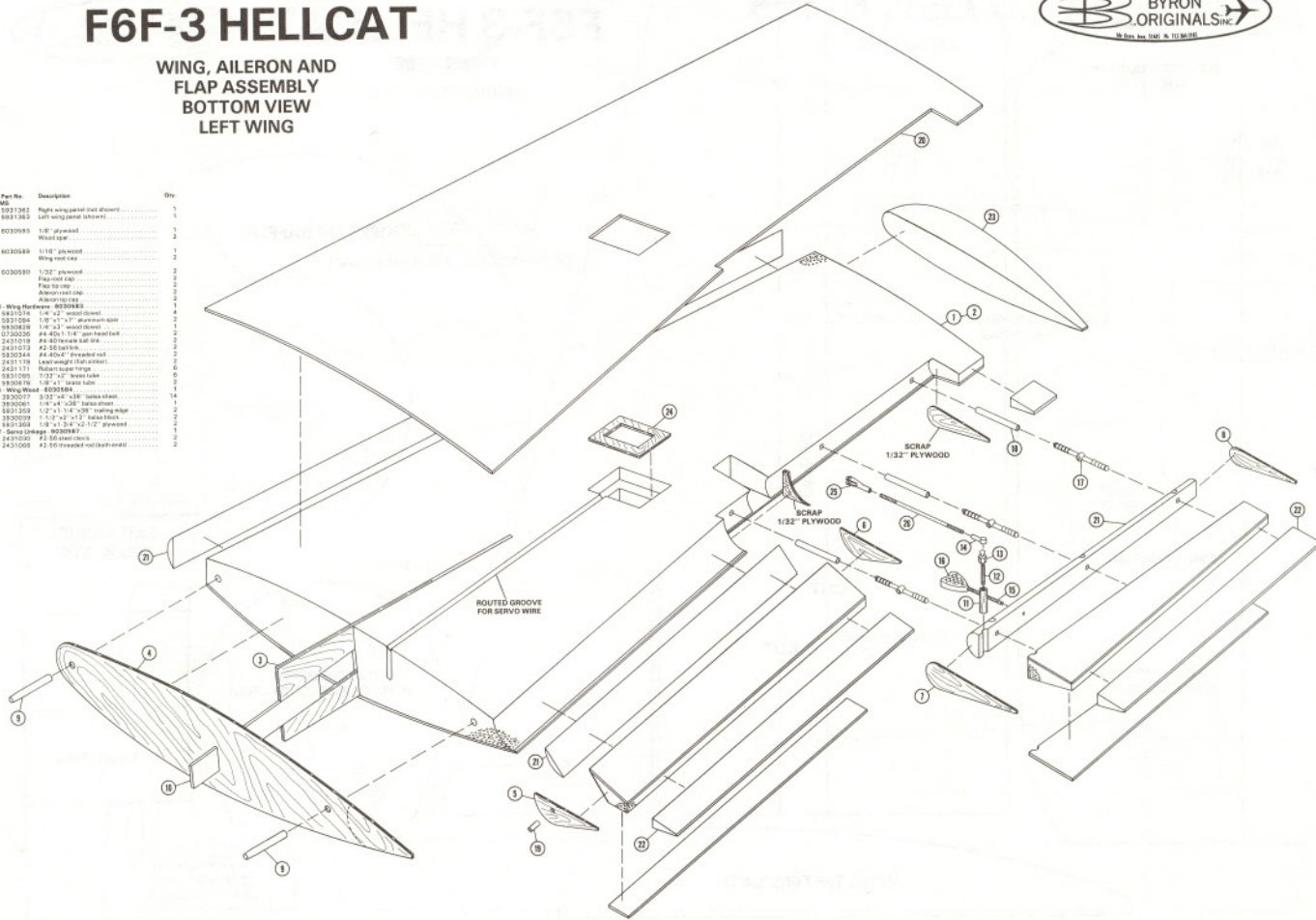

F6F-3 HELLCAT

SERVO LINKAGE

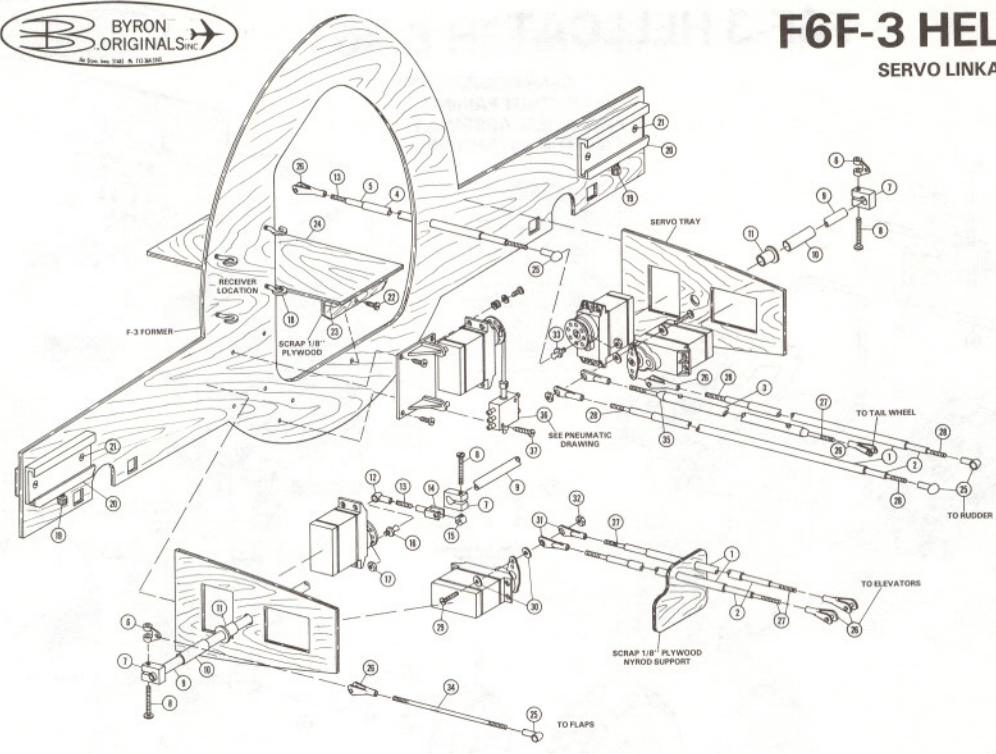

| Part No. | Part No. | Description | Qty. |
|---|----------|----------------------------------|------|
| 1 | 2030003 | 48" clear nylon rod | 4 |
| 2 | 2030001 | 48" yellow clear nylon | 4 |
| 3 | 2030002 | 1/4" x 2 1/2" fiberglass pushrod | 1 |
| 4 | 8303234 | 18" clear nylon rod | 1 |
| 5 | 8301102 | 18" yellow nylon rod | 1 |
| Bag No. 1 - Fastener Hardware - 8030881 | | | |
| 6 | 1425118 | Nylon screw | 2 |
| 7 | 8826421 | Aluminum bar clamp | 3 |
| 8 | 0720078 | #4-40 x 1/8" pan head screw | 2 |
| 9 | 8801276 | 1/4" x 1 1/2-3/8" aluminum tube | 2 |
| 10 | 8801275 | 1/4" x 1 1/2-3/8" aluminum tube | 2 |
| 11 | 2431122 | 1" nylon bearing | 2 |
| 12 | 2431120 | Nylon ball socket | 2 |
| 13 | 2431007 | #2-56 x 1/2" threaded rod | 2 |
| 14 | 2431170 | 1/4" x 3/4" length use both ends | 1 |
| 15 | 2431109 | Nylon screw #20 | 1 |
| 16 | 2431075 | #2-56 nut #20 | 1 |
| 17 | 1420478 | #2-56 hex nut | 4 |
| 18 | 0720078 | 1" nylon bearing | 2 |
| 19 | 0720115 | #10-32 x 1/4" nylon ball bush | 2 |
| 20 | 0720078 | 1" aluminum bearing | 2 |
| 21 | 0720075 | #4-40 x 3/8" flat head screw | 2 |
| 22 | 0720045 | #2-3/8" sheet metal screw | 1 |
| Bag No. 2 - Fastener Hardware - 8030882 | | | |
| 23 | 8801073 | 1/4" x 3" screw | 1 |
| 24 | 8801088 | 1/8" x 1 1/2" screw | 1 |
| Bag No. 3 - Servo Linkage - 8030887 | | | |
| 25 | 2431120 | Nylon screw #20 | 1 |
| 26 | 2431026 | #2-56 nut #20 | 1 |
| 27 | 2431025 | #2-56 nut #20 | 1 |
| 28 | 2431024 | #2-56 nut #20 | 1 |
| 29 | 0720041 | 1/4" x 3/4" length use both ends | 2 |
| 30 | 1330206 | 3/8" washer #20 | 4 |
| 31 | 2431161 | #2-56 wing nut #20 | 2 |
| 32 | 1420478 | #2-56 nut | 9 |
| 33 | 2431075 | #2-56 nut #20 | 2 |
| 34 | 2431111 | #2-56 nut threaded end both ends | 2 |
| 35 | 0720075 | #4-40 x 3/8" flat head screw | 2 |
| Bag No. 4 - Pneumatic Hardware - 8030883 | | | |
| 36 | 2431164 | Single strand cable | 1 |
| 37 | 0720075 | #4-40 x 3/8" flat head screw | 2 |



FIBERGLASS PUSHROD ASSEMBLY TO ASSEMBLE PUSHROD

1. DRILL HOLE 1" FROM END OF FIBERGLASS TO FIT #2-56 x 4" ROD
2. SLIDE NYLON END CAP, BULLET END FIRST UNTO UNTHREADED END OF ROD.
3. BEND UNTHREADED END OF #2-56 ROD AT A 90° ANGLE AND CUT TO 1/4"
4. INSTALL ROD THROUGH HOLE AS SHOWN AND WITH EPOXY OR SLOW TYPY CYANOACRYLATE GLUE NYLON END CAP INTO FIBERGLASS TUBE.
5. INSTALL AND CUT OTHER END OF FIBERGLASS TUBE TO PROPER LENGTH AND REPEAT PROCEDURE.

F6F-3 HELLCAT

FUSELAGE FLAP ASSEMBLY

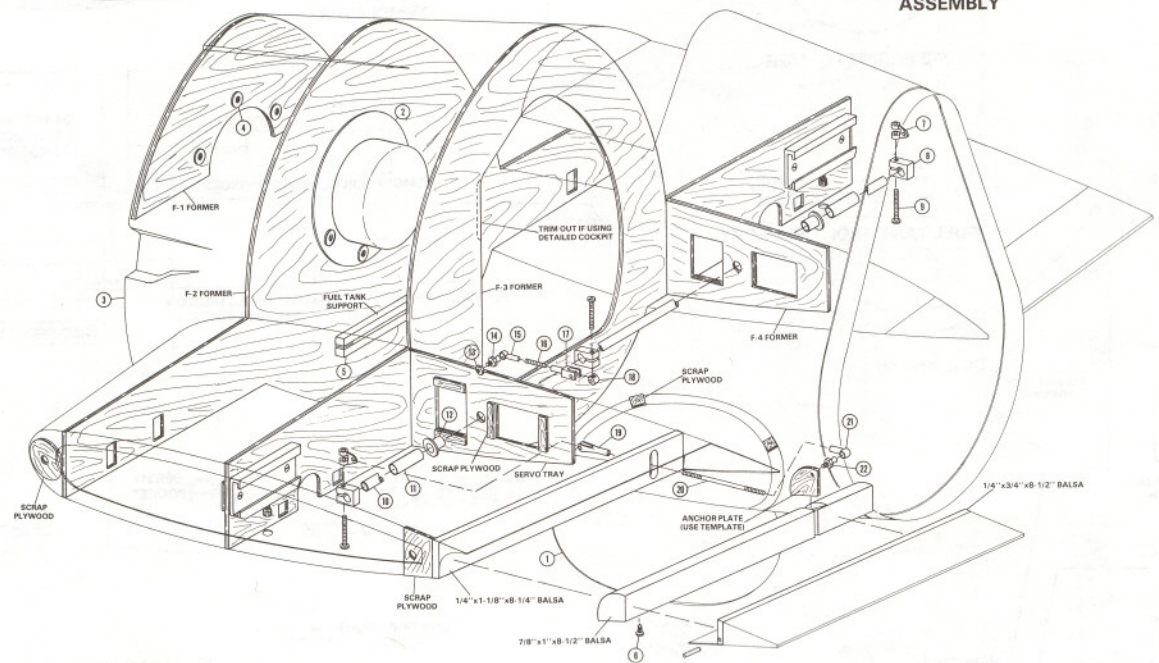

| Part No. | Part No. | Description | Qty. |
|--|----------|----------------------------------|------|
| BULK ITEM | | | |
| 1 | 9831355 | Fiberglass belly pan | 1 |
| 2 | 9831351 | Fiberglass motor cap | 1 |
| 3 | 9831353 | Fiberglass landing wheel | 1 |
| Bag No. 1 - Fastener Hardware - 8030881 | | | |
| 4 | 1420500 | #8-32 Black Flat | 1 |
| 5 | 8802073 | 1/4" x 3" screw | 2 |
| 6 | 0720069 | #2 x 3/8" pan head screw | 10 |
| 7 | 2431118 | Nylon connector | 2 |
| 8 | 8826421 | Aluminum bar clamp | 3 |
| 9 | 0720078 | 1" nylon bearing | 2 |
| 10 | 8801276 | 1/4" x 1 1/2-3/8" aluminum tube | 2 |
| 11 | 8801275 | 1/4" x 1 1/2-3/8" aluminum tube | 2 |
| 12 | 2431122 | 1" nylon bearing | 1 |
| 13 | 1420478 | #2-56 hex nut | 1 |
| 14 | 2431075 | #2-56 nut #20 | 1 |
| 15 | 2431020 | Nylon ball socket | 1 |
| 16 | 2431087 | #2-56 x 1/2" threaded rod | 1 |
| 17 | 2431110 | Nylon screw #20 | 1 |
| 18 | 2431109 | Nylon screw #20 | 1 |
| Bag No. 2 - Servo Linkage - 8030887 | | | |
| 19 | 2431120 | Nylon screw #20 | 1 |
| 20 | 2431111 | #2-56 nut threaded end both ends | 1 |
| 21 | 2431102 | Nylon ball socket | 1 |
| 22 | 2431073 | #2-56 nut #20 | 1 |

COVERING FLAP SEE INSTRUCTION MANUAL (COVERING MATERIAL IS ALSO FLAP HINGE)

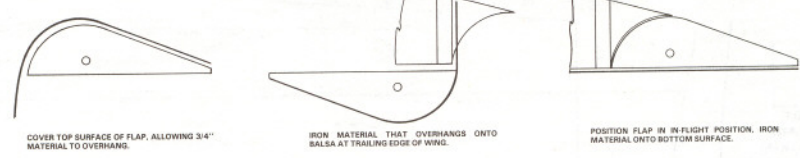

COVER TOP SURFACE OF FLAP, ALLOWING 3/4" MATERIAL TO OVERHANG.

IRON MATERIAL THAT OVERHANGS ONTO Balsa AT TRAILING EDGE OF WING.

POSITION FLAP IN IN-FLIGHT POSITION, IRON MATERIAL ONTO BOTTOM SURFACE.

F6F-3 HELLCAT



GEAR DOOR, GEAR STRUT FAIRING, AND WHEEL ASSEMBLY RIGHT MAIN SHOWN

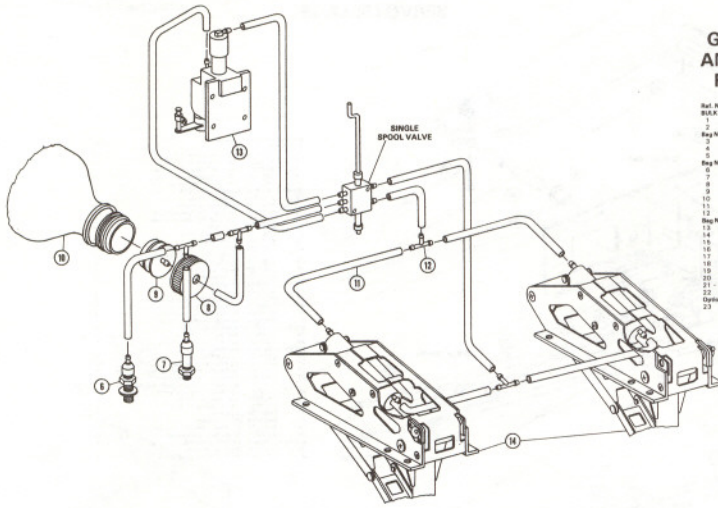

| Ref. No. | Part No. | Description | Qty. |
|----------|----------|--------------------------------|------|
| 1 | 8321355 | Left gear landing strut shock | 1 |
| 2 | 8321361 | Right gear landing strut shock | 1 |
| 3 | 8321362 | Left landing gear tail | 2 |
| 4 | 8321367 | Right landing gear tail | 2 |
| 5 | 8321368 | Pushrod - wheel gear struts | 12 |
| 6 | 8321369 | Pushrod - wheel gear struts | 6 |
| 7 | 8321370 | Pushrod - wheel gear struts | 6 |
| 8 | 8321371 | Pushrod - wheel gear struts | 6 |
| 9 | 8321372 | Pushrod - wheel gear struts | 6 |
| 10 | 8321373 | Pushrod - wheel gear struts | 6 |
| 11 | 8321374 | Pushrod - wheel gear struts | 6 |
| 12 | 8321375 | Pushrod - wheel gear struts | 6 |
| 13 | 8321376 | Pushrod - wheel gear struts | 6 |
| 14 | 8321377 | Pushrod - wheel gear struts | 6 |
| 15 | 8321378 | Pushrod - wheel gear struts | 6 |
| 16 | 8321379 | Pushrod - wheel gear struts | 6 |
| 17 | 8321380 | Pushrod - wheel gear struts | 6 |
| 18 | 8321381 | Pushrod - wheel gear struts | 6 |
| 19 | 8321382 | Pushrod - wheel gear struts | 6 |
| 20 | 8321383 | Pushrod - wheel gear struts | 6 |
| 21 | 8321384 | Pushrod - wheel gear struts | 6 |
| 22 | 8321385 | Pushrod - wheel gear struts | 6 |
| 23 | 8321386 | Pushrod - wheel gear struts | 6 |

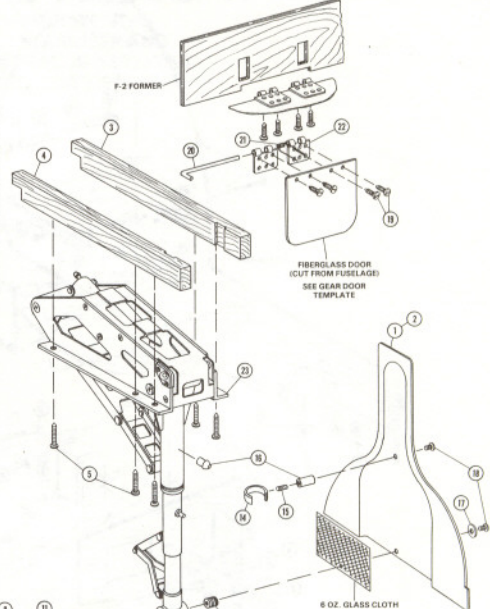

PNEUMATIC SYSTEM OPTIONAL

| Ref. No. | Part No. | Description | Qty. |
|----------|----------|-------------------------------|-------|
| 1 | 8321387 | 3/8" air hose | 1 |
| 2 | 8321388 | 1/16" wheel collar with screw | 2 |
| 3 | 8321389 | 2" nylon rod | 2 |
| 4 | 8321390 | 2" x 1/4" nylon roller | 1 |
| 5 | 8321391 | Single spool valve | 1 |
| 6 | 8321392 | Air filter | 1 |
| 7 | 8321393 | Air pressure gauge | 1 |
| 8 | 8321394 | Air hose cap | 1 |
| 9 | 8321395 | Barb elbow | 1 |
| 10 | 8321396 | Air hose | 1 |
| 11 | 8321397 | 1/16" air line (10') | 4 |
| 12 | 8321398 | 1/16" air line | 1 |
| 13 | 8321399 | OAR reservoir | 1 |
| 14 | 8321400 | Remote 100' coiled hose | 1 set |

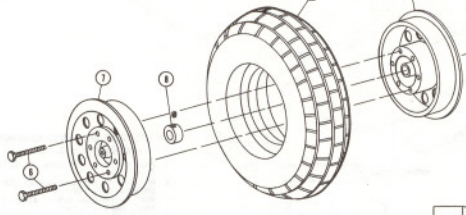

MAIN GEAR ALTERATION

TO ALLOW MAIN GEAR TO FIT WELL THE GEAR STRUT MUST BE EXTENDED. THIS CAN BE ACCOMPLISHED BY (1) REMOVING C-CLIP AND PIN FROM KNEE. (2) FILE OFF MATERIAL ON STOP AS SHOWN IN DRAWING. MAKE SURE THAT YOU DO NOT REMOVE TOO MUCH. ASSEMBLE AND CHECK LENGTH AS SHOWN IN DRAWING. IF IT DOES NOT MEASURE 5-1/2" - REMOVE PIN AND FILE OFF MORE. RE-ASSEMBLE AND CHECK.

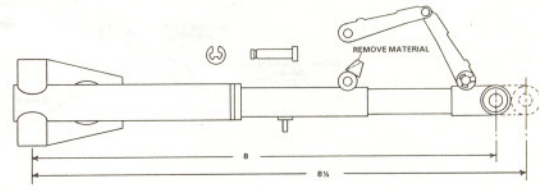

F6F-3 HELLCAT



TEMPLATES

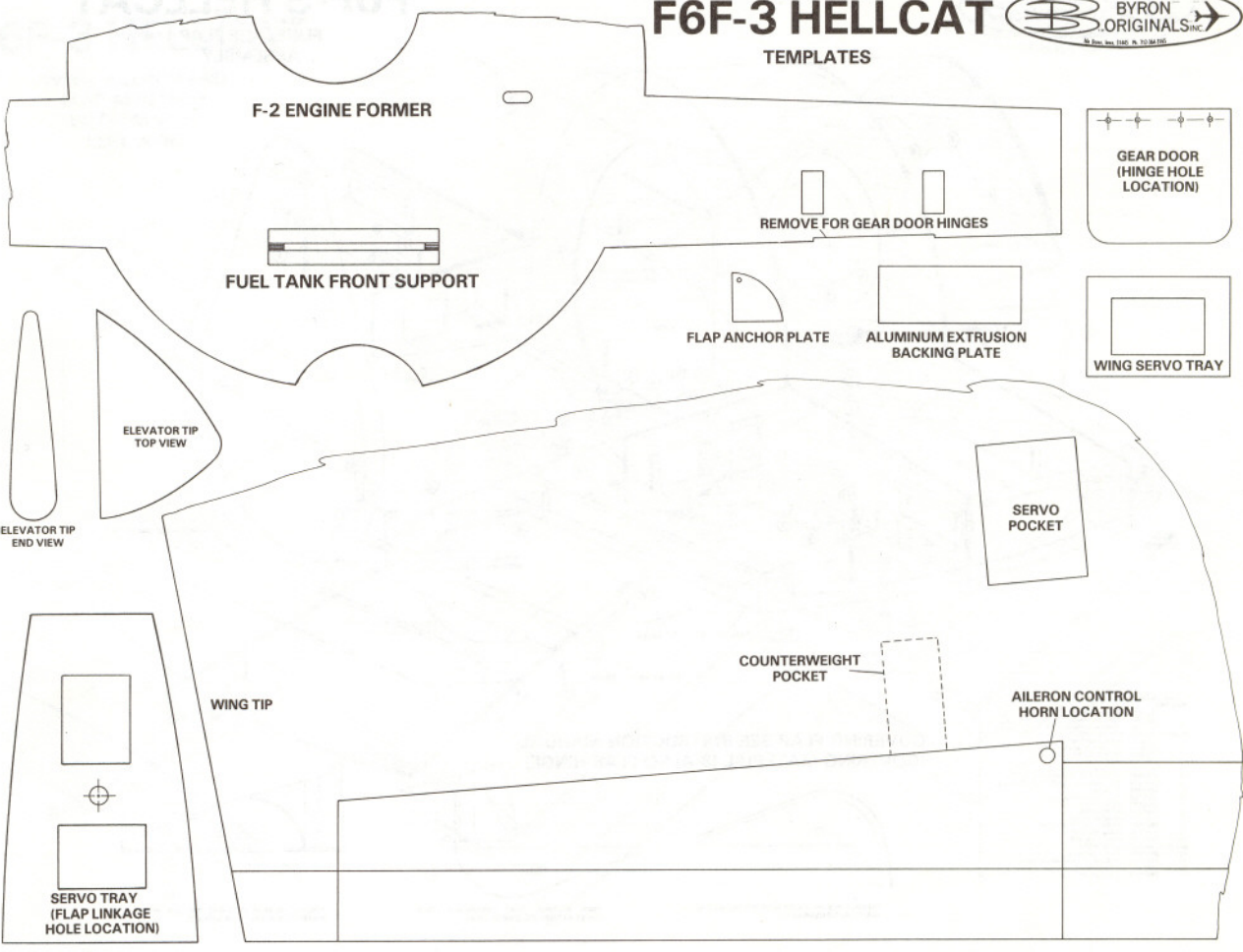

F-2 ENGINE FORMER

FUEL TANK FRONT SUPPORT

ELEVATOR TIP TOP VIEW

ELEVATOR TIP END VIEW

WING TIP

SERVO TRAY (FLAP LINKAGE HOLE LOCATION)

REMOVE FOR GEAR DOOR HINGES

GEAR DOOR (HINGE HOLE LOCATION)

FLAP ANCHOR PLATE FAIRING MOUNT

ALUMINUM EXTRUSION BACKING PLATE

WING SERVO TRAY

SERVO POCKET

COUNTERWEIGHT POCKET

AILERON CONTROL HORN LOCATION

RUDDER TEMPLATES AND RUDDER ASSEMBLY

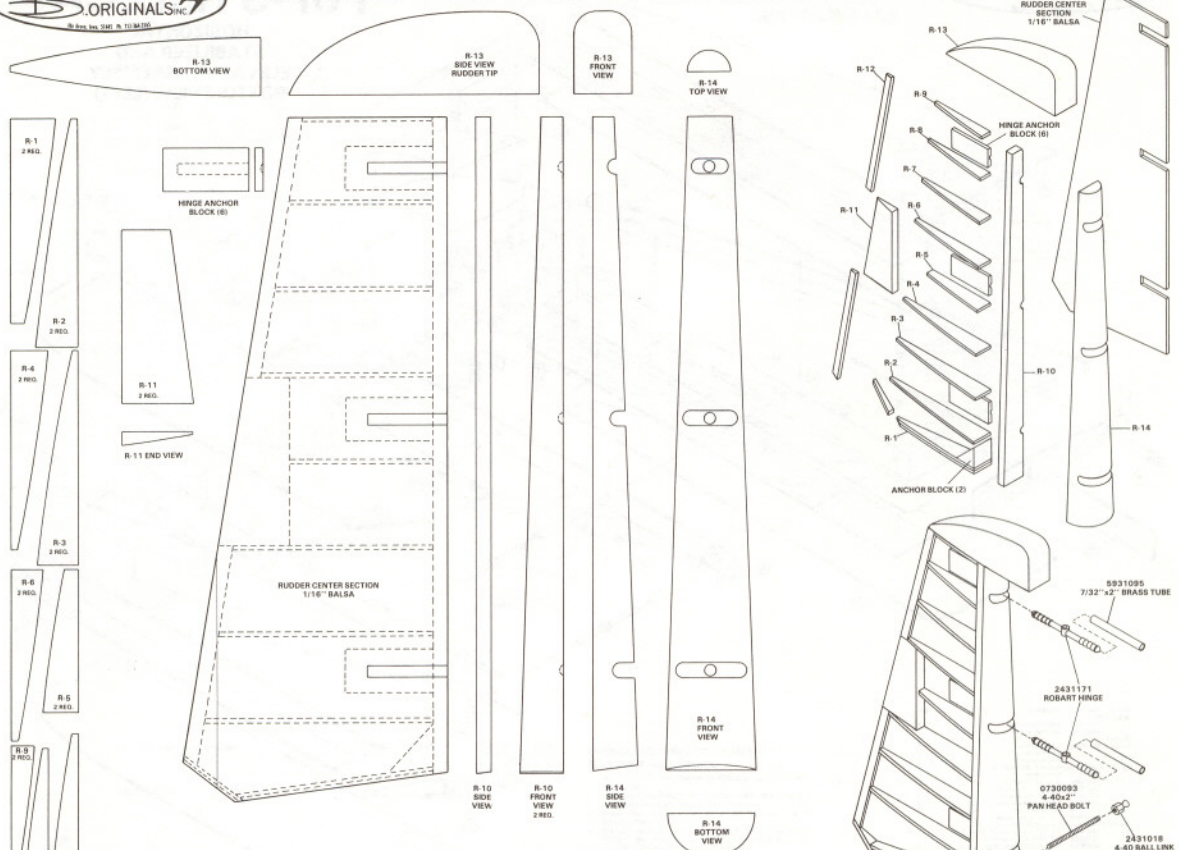

F6F-3 HELLCAT

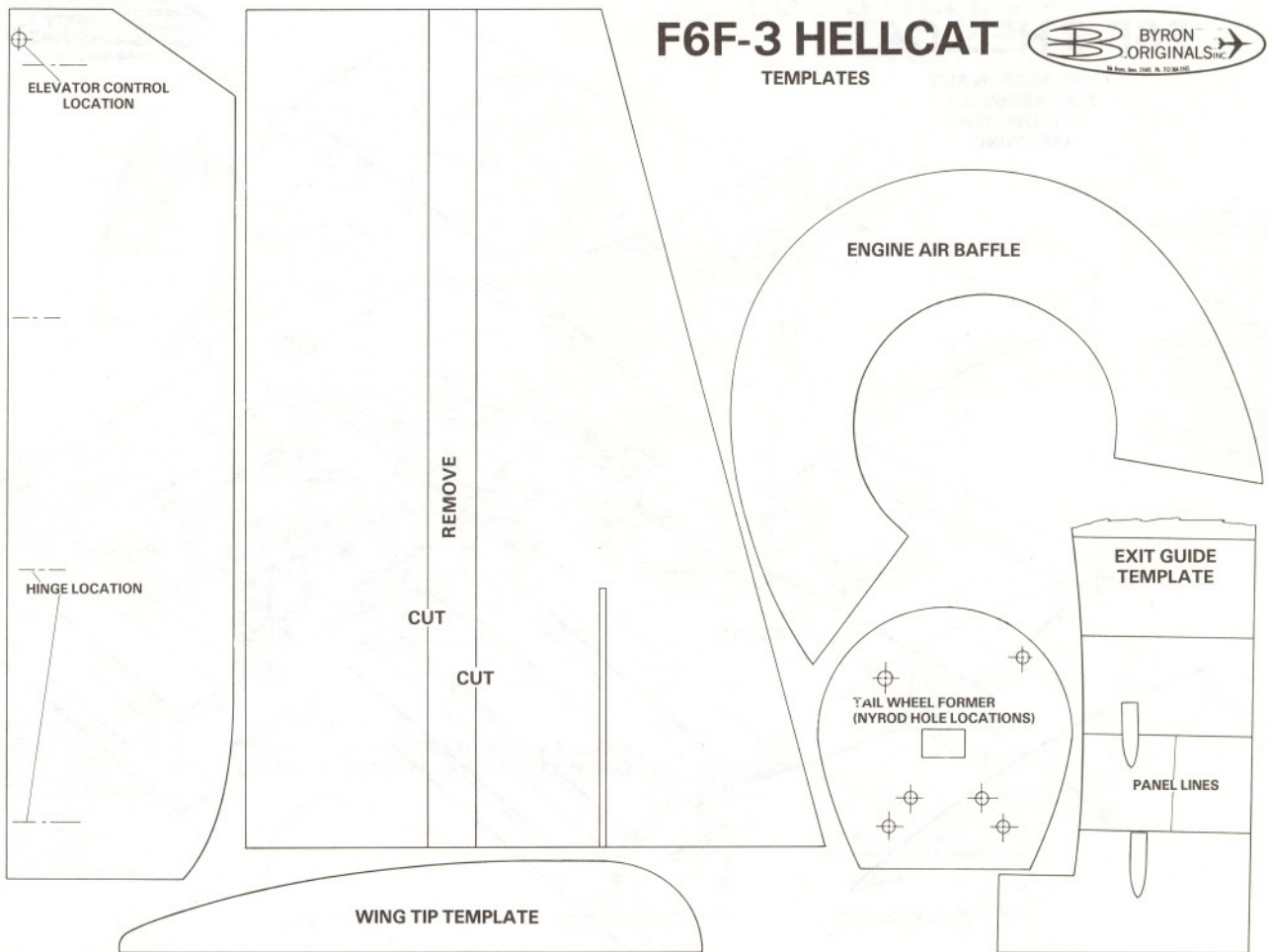
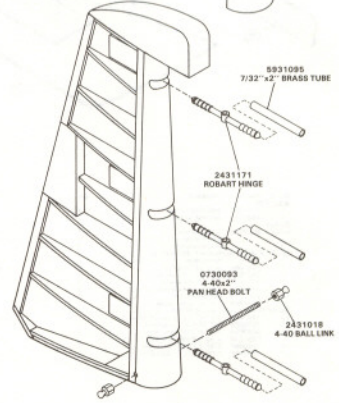

F6F-3 HELLCAT TEMPLATES